

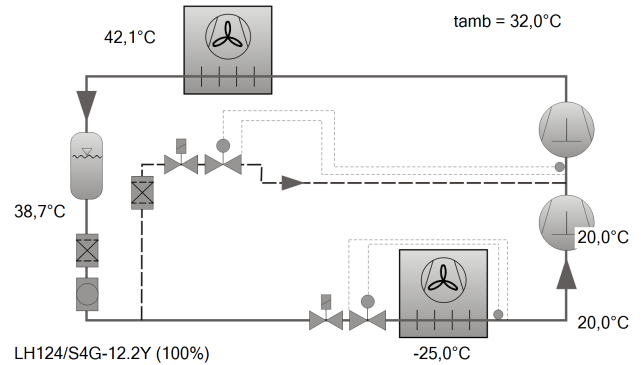

Selection: Condensing Units 2-stage

Input Values

Unit type	(LH124/S4G-12.2Y)
Refrigerant	R404A
Reference temperature	Dew point temp.
Evaporating SST	-25,00 °C
Ambient temp.	32,0 °C
Operating mode	without subcooler
Suction gas temperature	20,00 °C
Useful superheat	100%
Power supply	400V-3-50Hz



Result

Unit type	LH124/S4G-12.2Y-40P
Capacity steps	100%
Cooling capacity	14,31 kW
Evaporator capacity	14,31 kW
Power input	10,04 kW
Current (400V)	17,41 A
Voltage range	380-420V
Mass flow LP	387 kg/h
Mass flow HP	393 kg/h
Condensing SDT	42,1 °C
Liquid subcooling	3,00 K

Power input compressor, power input fan see "T. Data"

Application Limits

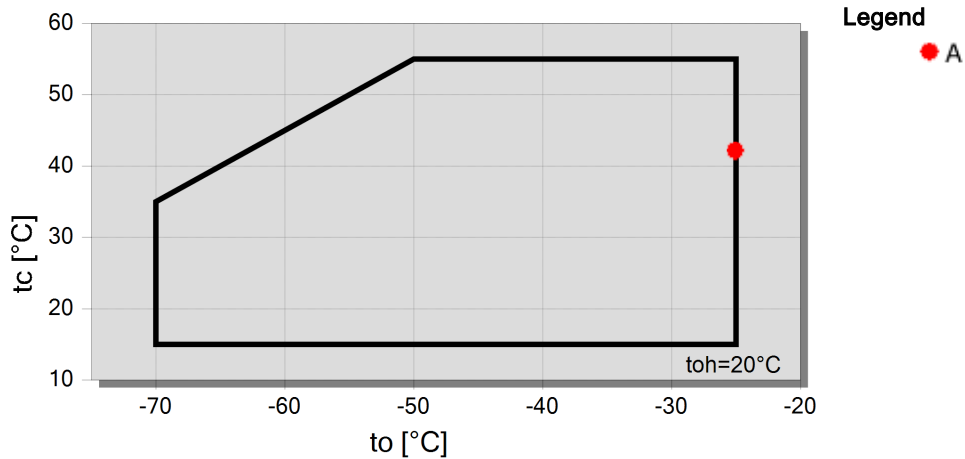



Technical Data: (LH124/S4G-12.2Y)

Dimensions and Connections

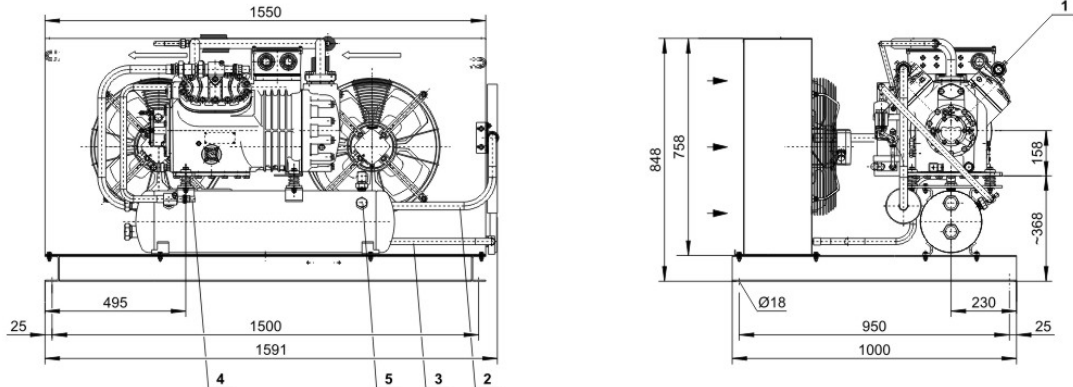

Technical Data

Technical Data

Displacement (1450 RPM 50Hz)	42.30 / 27.00 m ³ /h
Displacement (1750 RPM 60Hz)	51.05 / 32.59 m ³ /h
Weight	348 kg
Total width	1591 mm
Total depth	1000 mm
Total height	848 mm
Connection suction line	35 mm - 1 3/8"
Connection liquid line	22 mm - 7/8"
Fans: Number	2
Voltage (50Hz, more on request)	230V-1-50Hz (Standard)
Current / Power consumption of each fan (50Hz)	3,08 A / 483 W
Air flow condenser 50Hz	9100 m ³ /h
Voltage (60Hz, more on request)	230V-1-60Hz (Standard)
Current / Power consumption of each fan (60Hz)	2,86 A / 593 W
Air flow condenser 60Hz	10494 m ³ /h
Coil Volume	15,0 dm ³
Receiver type (Standard)	F302H
Max. refrigerant charge 90% at 20°C / 68°F	
R22	32,7 kg
R404A/R507A	28,8 kg

Available Options

Fans: elect. Speed regulator	Option
Oil separator with check valve	Option
High & low pressure switch	Option
Liquid sub cooler (also mounted)	Option
Data of compressors: see compressor program	



Condensing Untis 2-stage

Note

For R22 applications the CIC-system can be used instead of a thermostatic post-injection valve.
For R404A / R507A applications the use of the CIC-system is not recommended.

Legend of connection positions according to "Dimensions":

- 1 Suction gas inlet
- 2 Discharge line
- 3 Condensate line
- 4 Refrigerant outlet
- 5 Pressure relief valve connection

Dimensions can show tolerances according to EN ISO 13920-B.